



CASCADE VILLAGE
SHOPPING CENTER

**RETAIL SPACE
FOR LEASE**
63455 N. Hwy. 97
Bend, OR 97703

SUITE VS-180



Between Dakota's Brick Shop and Pretty Moments



2,040 SF | \$26/SF/Yr. NNN

NB NEVILLE & BUTLER
Commercial Real Estate

Steven Neville, Broker
Natalie Butler, Broker

900 SW 13th Avenue, Suite 210 | Portland, OR 97205
503.241.1222 | www.nevillebutler.com

COMPASS COMMERCIAL REAL ESTATE SERVICES

Russell Huntamer, CCIM
Eli Harrison, Broker

600 SW Columbia St., Ste. 6100 | Bend, OR 97702
541.383.2444 | www.CompassCommercial.com



CASCADE VILLAGE
SHOPPING CENTER

Cascade Village Shopping Center is a 367,850 square foot open-air center situated at the gateway to Bend, Oregon. Located at the confluence of Highways 20 and 97 on Bend's north end, the Center has exposure to almost 60,000 cars per day (ODOT 2020) and can be easily accessed from all directions.

SUITE VS-180

This 2,040 square foot retail space is next to the stairs/elevator to second floor. Near Village Plaza, a prime location near the shopping center's custom water/fire feature.

VILLAGE PLAZA

Village Plaza serves as a social gathering place and is where Cascade Village hosts entertainment events.



RETAIL SPACE FOR LEASE

63455 N. Hwy. 97
Bend, OR 97703

HIGHLIGHTS

- Located between Dakota's Brick Shop and Pretty Moments
- Located at one of three entrances to Village Shops and Village Plaza
- Angle parking located in front of space
- BendBroadband and gas services available
- 250 amp electrical service
- NNN's estimated at \$8.22/SF/Yr.
- Marketing fund at \$1.00/SF/Yr.

FLOOR PLAN

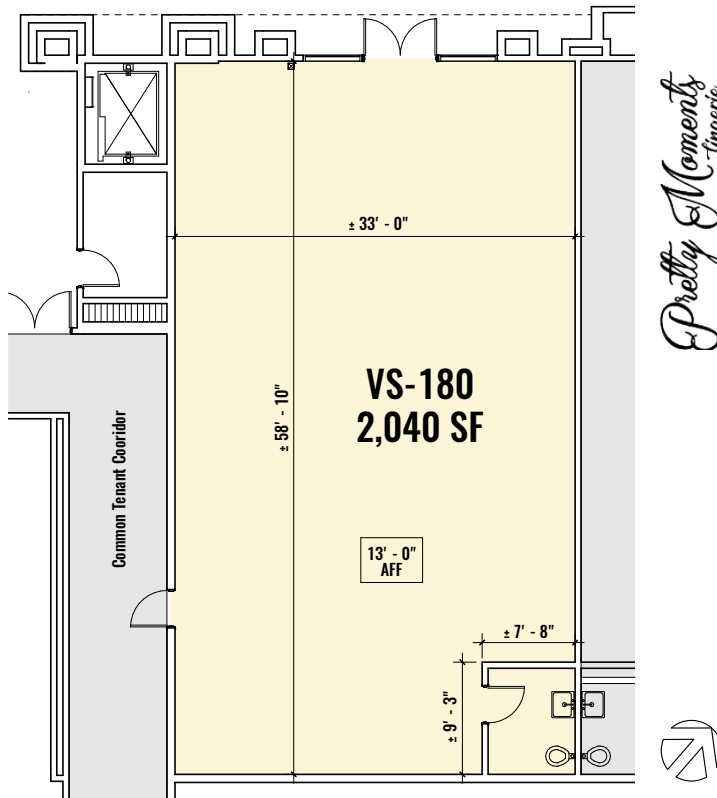

For More Information
Please Contact:



541.383.2444

Russell Huntamer, CCIM

rh@compasscommercial.com

Eli Harrison, Broker

eharrison@compasscommercial.com



503.241.1222

Steven Neville, Broker

steve@nevillebutler.com

Natalie Butler, Broker

natalie@nevillebutler.com

Brokers are licensed in the state of Oregon. This information has been furnished from sources we deem reliable, but for which we assume no liability. This is an exclusive listing. The information contained herein is given in confidence with the understanding that all negotiations pertaining to this property be handled through Compass Commercial Real Estate Services. All measurements are approximate.